

TOPOGRAPHICAL SURVEY  
 PROPOSED FIRE STATION  
 CITY OF NAPOLEON, OHIO

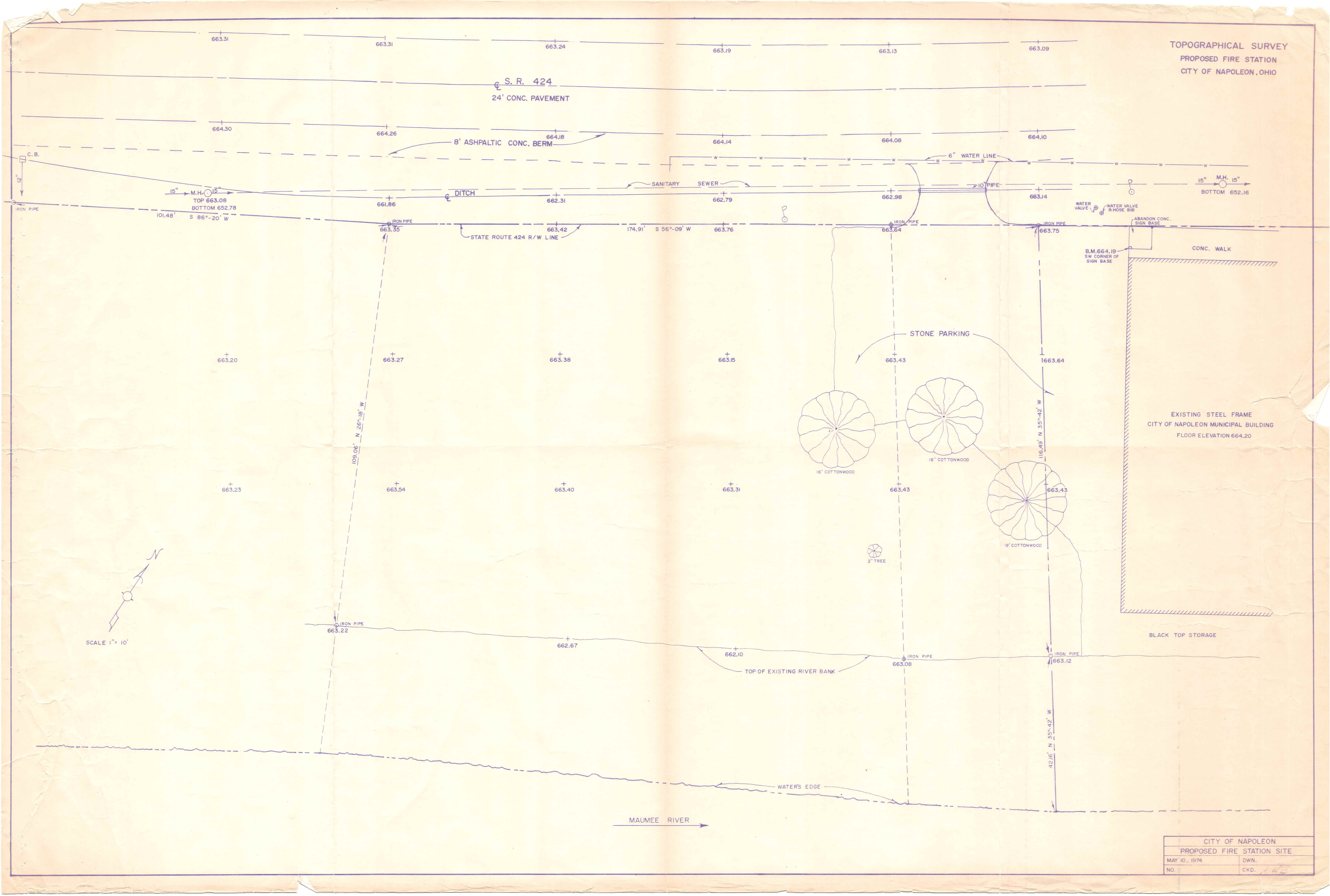

663.31

663.31

663.24

663.19

663.13

663.09

S. R. 424  
 24' CONC. PAVEMENT

664.30

664.26

664.18

664.14

664.08

664.10

8' ASPHALTIC CONC. BERM

C. B.

15" M.H.  
 TOP 663.08  
 BOTTOM 652.78

101.48' S 86°-20' W

661.86

662.31

662.79

662.98

663.14

WATER VALVE & HOSE BIB

15" M.H. 15"  
 BOTTOM 652.16

STATE ROUTE 424 R/W LINE

174.91' S 56°-09' W

663.76

663.64

663.75

B.M. 664.19  
 SW CORNER OF  
 SIGN BASE

CONC. WALK

663.20

663.27

663.38

663.15

STONE PARKING

663.43

663.64

109.06' N 26°-18' W

116.49' N 35°-42' W

EXISTING STEEL FRAME  
 CITY OF NAPOLEON MUNICIPAL BUILDING  
 FLOOR ELEVATION 664.20

663.23

663.54

663.40

663.31

16" COTTONWOOD

16" COTTONWOOD

16" COTTONWOOD

18" COTTONWOOD

2" TREE

663.43

663.43

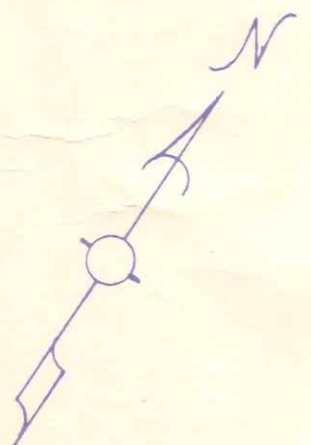

SCALE 1" = 10'

IRON PIPE  
 663.22

662.67

662.10

663.08

663.12

TOP OF EXISTING RIVER BANK

BLACK TOP STORAGE

WATER'S EDGE

MAUMEE RIVER

42.16' N 38°-42' W

CITY OF NAPOLEON	
PROPOSED FIRE STATION SITE	
MAY 10, 1974	DWN.
NO.	CKD. <i>AWC</i>